

COOKERHOODS

60 cm - 70 cm - 90 cm

DCH290 DCH291 DCH291M

DCH293 DCH294

DCH295 DCH296



Believe in better



Customer Care Line
(after sales service)

086 100 3339

Cooking
Instruction manual

INDEX

- 2 Before use.
- 2 Description.
- 2 Electrical connection.
- 2 Preparing for installation.
- 2 Recirculating filtered air.
- 2 Venting air to the outside.
- 3 Wall mounting.
- 4 Under cupboard installation.
- 4 Controls.
- 5 Safety advice.
- 5 Maintenance.
- 5 Grease filters.
- 5 Replacement filters.
- 6 Replacing a faulty light bulb.
- 6 Cleaning.
- 6 Owner's responsibility.
- 6 Problem check.
- 7 Branches.
- 8 Warranty.

Before use.

Remove all packaging and dispose of it in an environmentally friendly manner.

If the cooker hood is damaged in any way, do not use it. Report the damage to your dealer, who will take the necessary corrective action.

Description.

The cooker hood extracts cooking vapours and passes these through aluminium grease filters which absorb any solid particles in the cooking vapours.

Electrical connection.

- The cooker hood uses a 220-240V/50Hz power supply.
- If the mains power cord is damaged, it must be replaced by a qualified electrician.
- Should you require an installation with no visible wiring, an accessible 15 amp earthed socket may be fitted in the cupboard above or alongside the hood. (A qualified electrician should provide this facility).
- **The manufacturer and the seller do not accept responsibility for any damage due to incorrect electrical connection and or installation**
- **This cooker hood may not be used with a battery inverter power supply.**

Preparing for installation.

The cooker hood has the ability to either re-circulate the filtered air back into the kitchen, or to exhaust the filtered air through a vent in an outside wall. A lever on the motor housing can be set to either option. Decide on the preferred option before commencing with the installation.

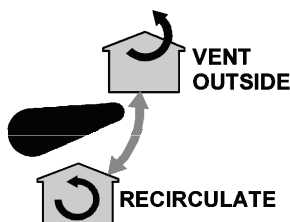

Recirculating filtered air.

- Filtered air is re-circulated, via vents on the upper surface of the hood, into the kitchen.
- Care must be taken during installation not to obstruct these vents.
- No ducting is required.

Venting air to the outside.

- Air may be vented to the outside by means of a flexible hose or ducted flue. This type of installation is best carried out by a competent technician.
- Two outside venting options are provided
A = Horizontal venting
B = Vertical venting
- Use the circular cover to close the option not required.

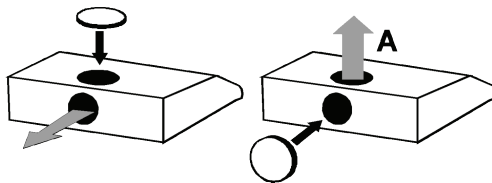

- When discharging filtered air into a flue or directly through the wall into the open, please take note of the following:
 1. Exhaust air from the hood must not be directed into a flue used for discharging the fumes or smoke from other appliances burning gas or fuels. See illustration below.

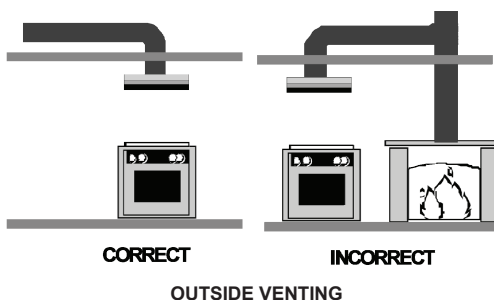

Wall mounting.

- The hood should be mounted onto a flat perpendicular kitchen wall.
- The hood must be mounted directly over the cooking area. The minimum distance between the cooking surface and the underside of the hood must be 650 mm for electric cookers and 750 mm for gas burners.

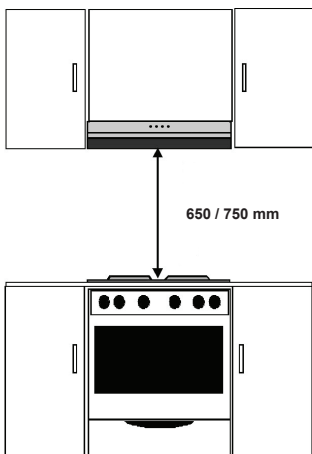

- Open the glass deflector panel by gently pulling forward on the lower edge.
- Remove the aluminium filters to expose the interior of the cooker hood.
- A Keyhole slot and a retainer hole will be visible on either side of the back panel.

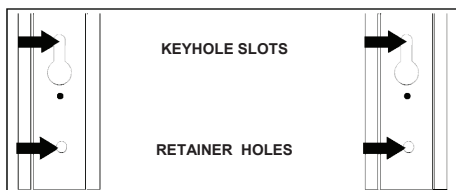

- Assistance may be required to perform the following installation tasks.
- Hold the hood in position against the wall so that it aligns with the previously drawn pencil lines.

- Mark out the location of the keyhole slots and retainer holes on the wall.
- Use a masonry bit to drill a hole in the wall at the top of each marked slot and retainer hole.
- Insert a rawl plug into each hole.

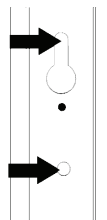

- Partly insert two pan head screws, with a head diameter slightly smaller than the lower opening in the keyhole slot, into the two upper rawl plugs.
- Leave about 5mm of the screw sticking out.

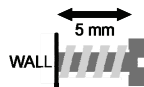

- Lift the cooker hood and slide the keyhole slots over the two pan head screws.
- Pull down and hang the cooker hood on the two screws.
- Tighten the screws.

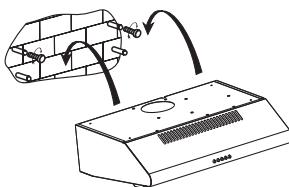

- To prevent accidental lifting of the cooker hood, fit a suitable screw into the two retainer hole rawl plugs.

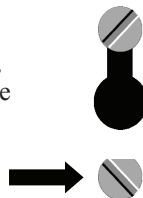

Under cupboard installation.

- If the cooker hood is to be mounted underneath a cupboard, the venting holes at the top/front of the hood must remain clear of the cupboard.
- Open the glass deflector panel by gently pulling forward on the lower edge.
- Remove the aluminium filters to expose the interior of the cooker hood
- Mark the bottom of the cupboard through the four fixing holes and drill through the cupboard at the marked positions.
- If required, cut a hole through the bottom of the cupboard sufficiently large enough to allow the power plug to pass through.
- Attach the cooker hood to the cupboard using 25mm x M4 bolts and nuts.
- Replace the aluminium filters.

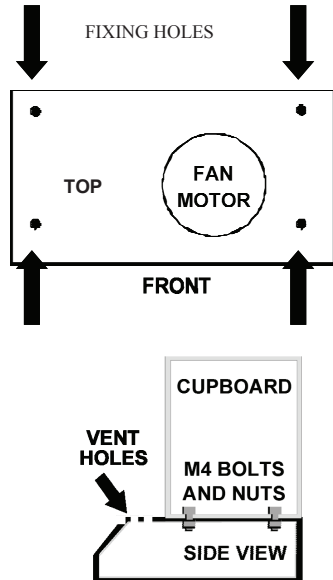

Controls.

- Plug the mains power cord into the wall socket and switch the power on.
- Switch the cooker hood on by selecting the desired fan speed. High, medium or low.
- If required, the cooking area may be illuminated by switching on the hood lights.
- Leave the hood running for a short period after cooking has been completed to clear any smoke and odours.

STOP



LOW



MEDIUM



HIGH



LIGHT



Safety advice.

This appliance is not intended for use by persons (including children) with reduced physical, sensory or mental capabilities, or lack of experience and knowledge, unless they have been given supervision or instruction concerning use of the appliance by a person responsible for their safety.

Children should be supervised to ensure that they do not play with the appliance.

There should be adequate ventilation of the room when the cooker hood is used at the same time as appliances using gas or other fuels.

The cooker hood is designed for domestic use only.

Do not operate the extractor hood without the grease filters in place.

Grease filters must be cleaned regularly to avoid accidental fires.

Do not leave cooking fat or oil unattended. Overheated fat or oil can easily catch fire.

Do not flambé food directly under the cooker hood. The flames pose the risk of the grease filter catching fire.

Switch off the power at the mains in the event of a fault or when cleaning the hood.

Do not touch any part of the light fittings while they are in use. They get hot and could cause discomfort.

Maintenance.

Aluminium Grease filters.

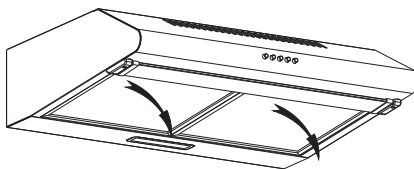

- Switch off the power at the mains when cleaning the hood
- When necessary, remove the filters and using a soft brush, wash them in a solution of lukewarm water and dishwashing liquid. Rinse, dry and refit.
- The filters may also be washed in a dishwasher
- When washing is no longer effective, the filter should be replaced.

Replacement filters.

- Replacement filters are available from Defy Parts/Service Centres nationwide.

Note: Excessively saturated filters negatively affect performance of the hood and could become a fire hazard if not cleaned regularly.

Optional Carbon pad filters.

- Carbon pad filters assist in removing cooking odours from the atmosphere.
- If filtered air is ducted to the outside, carbon pad filters are not required.
- **If required, factory approved, carbon pad filters may be purchased from your nearest Defy Service Centre.**

Carbon pad filters are used to purify the air which is released back into the room. The filters are not washable or reusable and must be replaced at least once every four months.

The active carbon filter saturation level depends on the frequency with which the appliance is used, the type of cooking performed and the regularity with which the anti-grease filters are cleaned.

Replacing faulty LED lights.

- Switch off the power at the mains.
- Remove the aluminium grease filters to expose the inside of the cooker-hood.
- Use a tool or the hand to press the spring splinter of both sides of LED light to the inside, until the light is pressed out. Then slightly pull the light connecting wire out and replace the new 2W LED lights.
- Apply the reverse procedure to install the light back.

Cleaning.

- **Switch off the power at the mains.**
- Use a damp soapy cloth to remove any accumulated dirt on the cabinet and glass deflector panel.
- Where applicable, stainless steel panels may be wiped lightly with baby oil to restore lustre and remove finger prints.

Do use

- A soft cloth.
- Synthetic sponge.
- Mild soap.
- Dishwashing liquid.
- A nylon bristle brush.

Do not use

- A steam cleaner.
- Flammable liquids
- Acids, abrasive cleaning powders or gels.
- Scourers, steel wool, metal scrapers, wire brushes or emery paper.
- So called “silver cleaners”.
- Products containing ammonia.

Problem check.

Before calling a service technician to assist with a problem please check:

- The main distribution board. See if a circuit breaker has tripped or a fuse has blown.
- The wall socket. Test with another appliance such as a kettle.
- Have the filters been cleaned?
- Is the flue or outlet pipe blocked?

Remember that you may be charged for a service call even during the warranty period if the fault is due to or caused by any of the above.

Owner's responsibility.

Since the following are not factory faults, they are the owner's responsibility.

- Damage to exterior finish.
- Breakage of glass and other components.
- Replacement of the light bulbs.
- Damage through improper use or installation of the hood.



Branches

If you have followed the instructions and still have a problem, contact the customer care line on 086 100 3339. They will be able to advise you on any aspect of the product or send a qualified technician to repair it.

South African Branches:

BLOEMFONTEIN

Unit Number 5
Monument Business Park
50 Monument Road
Oranjesig, Bloemfontein
Bloemfontein.Service@defy.co.za

CAPE TOWN

5A Marconi Rd. Montague Gardens, 7441
CapeTown.Service@defy.co.za

DURBAN

135 Teakwood Road, Jacobs,
Durban, 4052
Durban.Service@defy.co.za

EAST LONDON

Robbie de Lange Road, Wilsonia,
East London, 5201
EastLondon.Service@defy.co.za

GAUTENG, MIDRAND

127 15th Road, Cnr Pharmaceutical & 15th Rd,
Midrand, Gauteng
Gauteng.Service@defy.co.za

POLOKWANE

87 Nelson Mandela Drive, Superbia 0699
Polokwane.Service@defy.co.za

PORT ELIZABETH

112 Patterson Road, North End, Port Elizabeth
6001
PortElizabeth.Service@defy.co.za

Sub-Saharan Africa Branches:

ZAMBIA: SOUTHGATE INVESTMENTS LTD

Plot 1606, Sheki Sheki Road
P.O. Box 33681
Lusaka, 10101, Zambia
Tel: +260 0211 242332/3
Fax: +260 0211 242933
sgiservicecentre@microlink.zm

NAMIBIA: ATLANTIC DISTRIBUTORS (PTY) LTD

10 Tienie Louw Street, Northern Industrial Area
P.O. Box 21158, Windhoek, Namibia
Tel: (061) 216162
Fax: (061) 216134
atlantic@mweb.com.na

ZIMBABWE: TRADECOMAFRICA

Trade Com Africa, 183 Loreley Crescent
Msasa, Harare, Zimbabwe
Tel: +263 4 486165/6
Cell: +263 772 469010
Cell: +263 772 469011

BOTSWANA: RAY MORGAN AGENCIES

RMA Service Centre, Plot 48, East Gate
Gaborone International Commerce Park
Kgale View, Gaborone
Botswana
Tel: +267 390 3996 / 390 3912
Fax: +267 318 7376
Cell: +267 7134 6539
service@rma.co.bw; raja@rma.co.bw

SWAZILAND: LYND'S DISTRIBUTORS

P.O Box 716, Mbabane, Swaziland, H100
Tel: (00268) 2515 4310/8
Fax: (00268) 2518 4318

MOZAMBIQUE: COOL WORLD. LDA

Rua da Resistencia No. 97B R/C
Cell: +258 84 44 61 234
coolworldlda@hotmail.com
Nosso Show Room
Av: da Industrias, Parcela No.735 * 735A
Machava, Maputo

WARRANTY

This certificate is issued by DEFY APPLIANCES LIMITED manufacturers of Defy and Ocean products, hereinafter the Company, to the original purchaser only, of the appliance described on the certificate and shall constitute the only warranty given in respect of this appliance.

The Company warrants to the original purchaser that for a period of TWO YEARS from date of purchase the appliance is free from defect under normal domestic use, both in workmanship and material, subject to t following conditions.

1. Repair or replacement of any part of this appliance, found by the Company to be defective, shall be at the election of the Company. The Company reserves the right to effect such service through any of its Service Divisions or Authorised Service Dealers. The cost of such service shall be borne by the Company in full, provided that the appliance is located no further than 50 km from a Company Service Centre or an Authorised Service Dealer. Where the appliance is located beyond the 50 km radius, the purchaser shall be liable for the standard travelling charges, as determined by the Company.
CARRY IN SERVICE Microwave ovens, Compact cookers and small appliances are repaired in our service centres and are not collected from the customers home. Faulty units should be delivered to the purchasing dealer or to the nearest Company Service Centre for warranty repairs.
2. Rusted or corroded solid plates, vitreous enamelware, fuses and lamps are specifically excluded from these warranties. It is an express condition of these warranties that the purchaser takes due care and attention in the use and maintenance of the appliance. Abuse, misuse in conflict with operating instructions, connection to incorrect voltages and subjection to commercial use shall release the Company from its obligations.
3. This warranty shall become void and cease to operate if the appliance is dismantled by, or any repairs to the appliance are effected by any persons not duly authorised by the Company, or if substitute parts not approved by the Company are used in the appliance, or if the serial number of the appliance is removed.
4. The Company shall not be responsible for damages resulting from fire, flood, civil disturbances or any Act of God. The Company shall not, in terms of these warranties be responsible nor held liable for any consequential loss or damage of any kind caused by or due to the failure or malfunction of the appliance. The Company shall not be responsible for damages caused by insect and/or animal infestation.
5. The Company shall not be responsible for transportation or other costs other than those incurred within the provisions of Point 1 of this Certificate.
6. For warranties in the Republic of South Africa and Sub-Saharan Africa, please contact your nearest Defy office. Please refer to the previous page for respective South African branches and Sub-Saharan Africa branches.
7. Where service is requested under warranty and no fault or defect can be found by the Company, all costs incurred will be for the purchaser's account.
8. This Certificate as well as your invoice will serve as proof of purchase. For the purpose of warranty, it will be essential to produce this Certificate and invoice. Failure to do so, will render the purchaser liable for service costs.

**KEEP THIS CERTIFICATE AND SALES INVOICE AS PROOF OF PURCHASE
FOR WARRANTY PURPOSES.**

For future reference, record the listed information in the space below. The serial number label is located on the inner wall of the cabinet and is exposed by removing the aluminium grease filters.

SERIAL No......

DATE OF PURCHASE.....

PURCHASED FROM.....