

**SIS 6126 R**  
**SteamXtra® STEAM STATION**



Believe in better



**Customer Care Line**  
(after sales service)





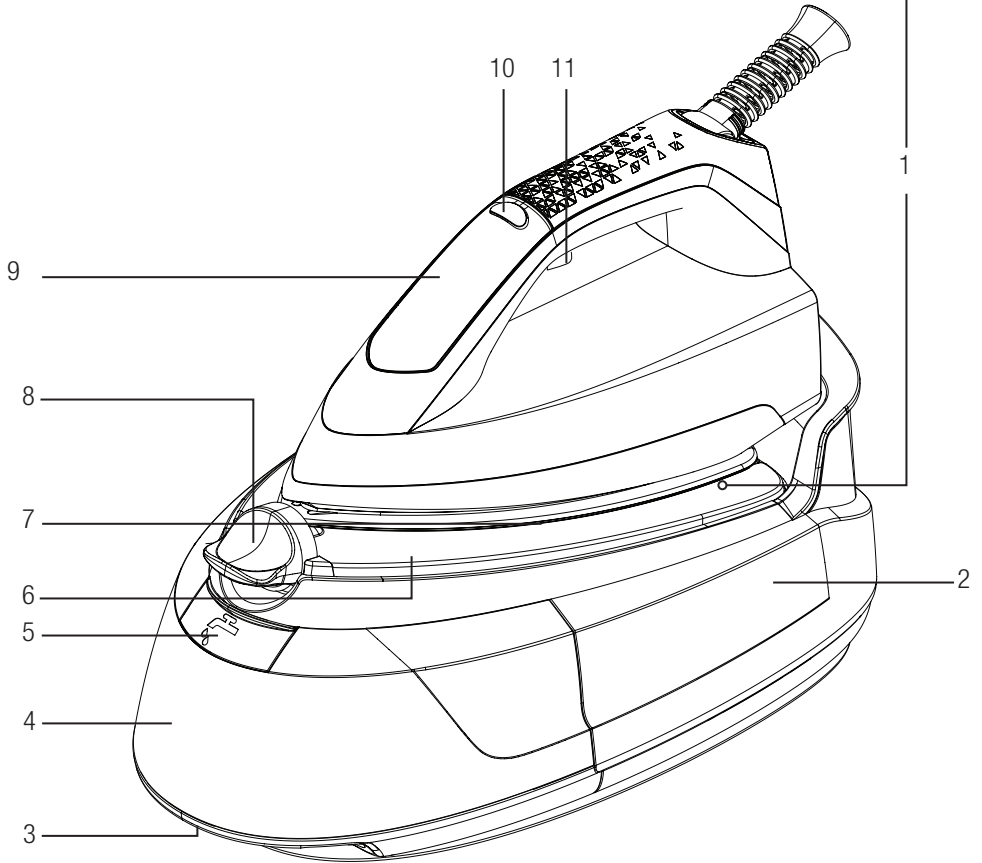
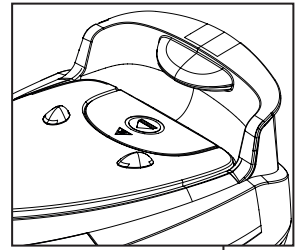

086 100 3339

4710M-8913533600-2622-01

**Small Appliance**  
Instruction manual





			
<b>EN</b>	FIRST USE	OPERATION	AUTOMATIC SHUTDOWN
			
<b>EN</b>	CLEANING AND CARE	CARTRIDGE CHANGE	SELF-CLEAN

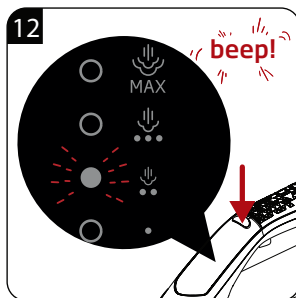
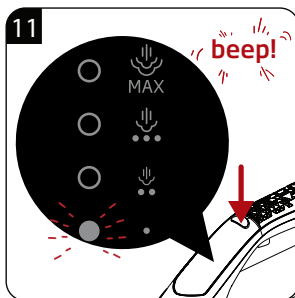
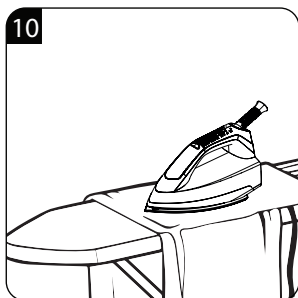
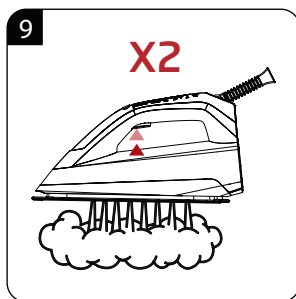
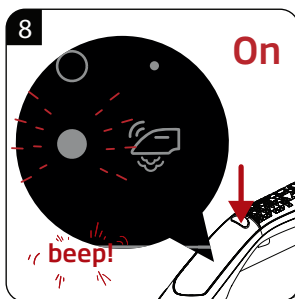
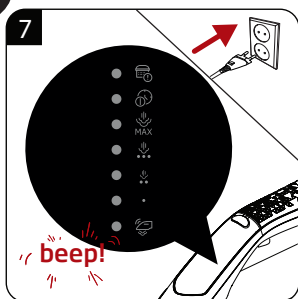
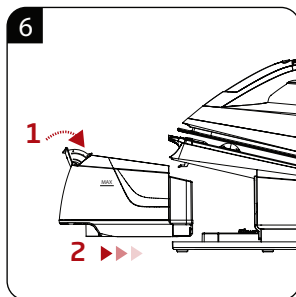
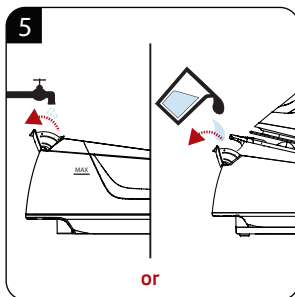
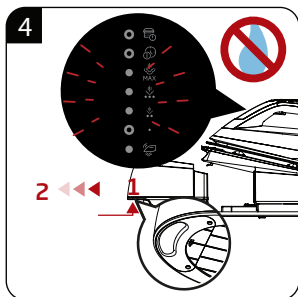
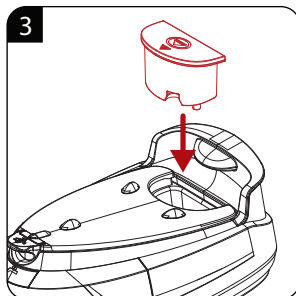
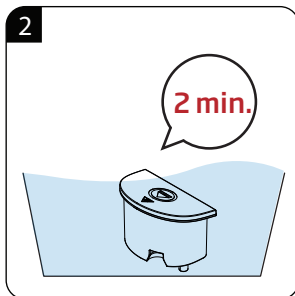
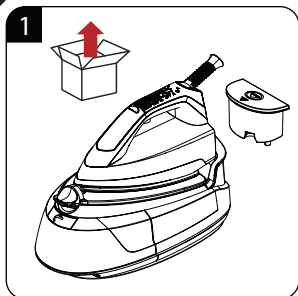

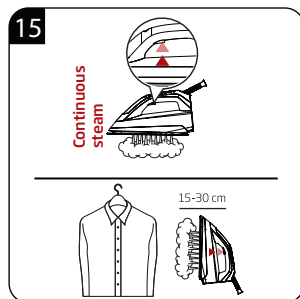
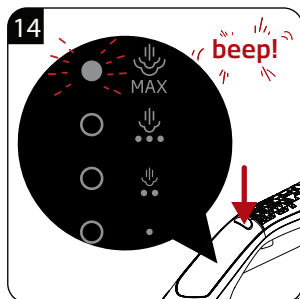
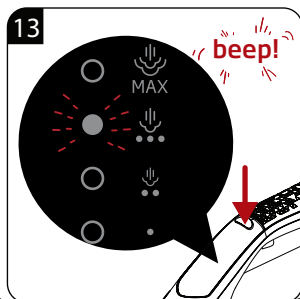

Auto-Off

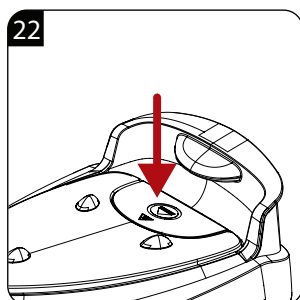
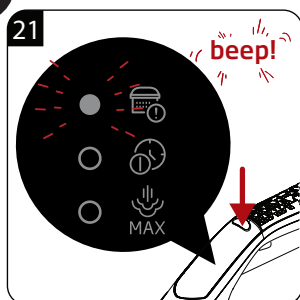
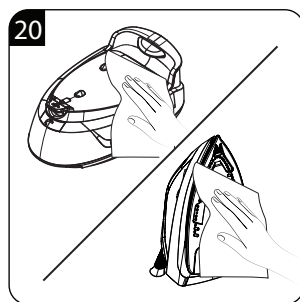
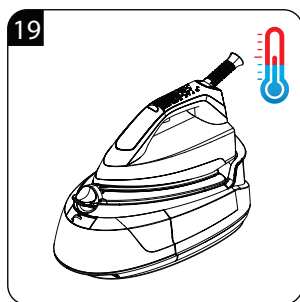
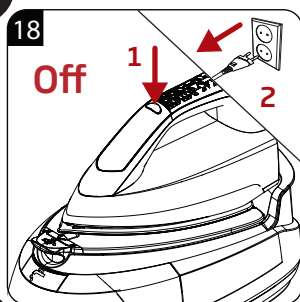
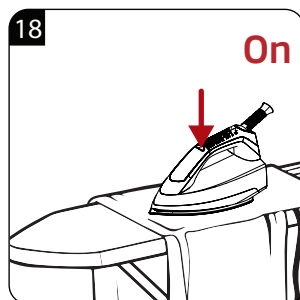
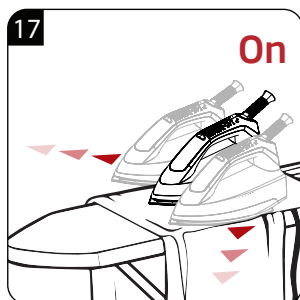
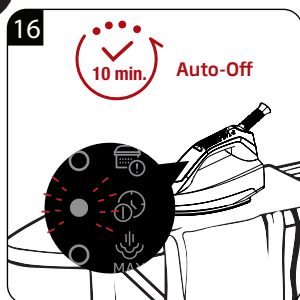

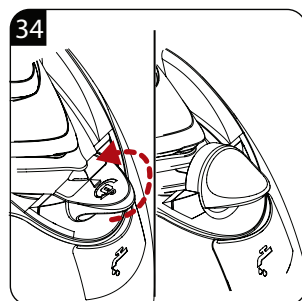
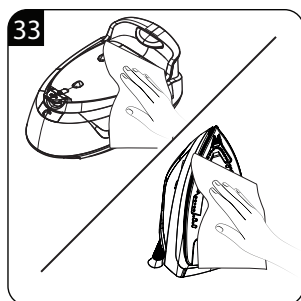
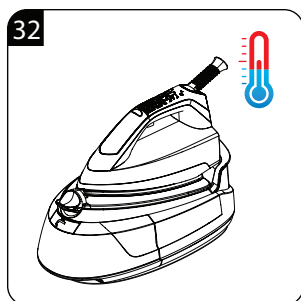
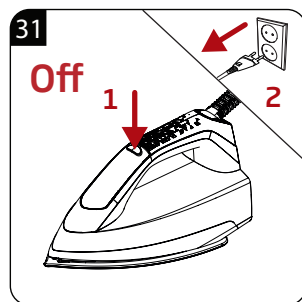
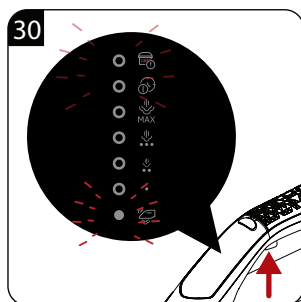
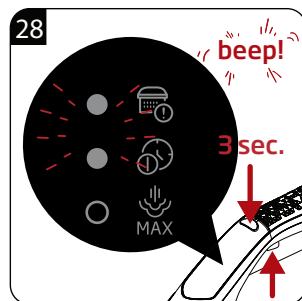
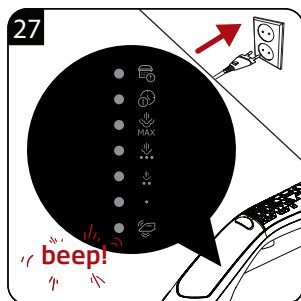
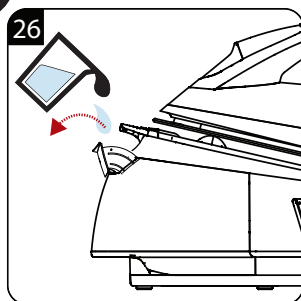
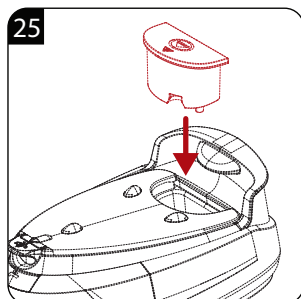
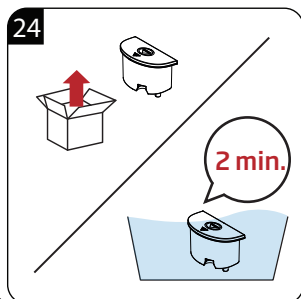

## Please read this manual first!

Dear Customer,

Thank you for preferring this Defy product. We hope that you get the best results from your product which has been manufactured with high quality and state-of-the-art technology. Therefore, please read this user manual and all other accompanying documents carefully before using the product and keep it as a reference for future use. If you handover the product to someone else, give the user manual as well. Follow all warnings and information in the user manual.

## Meanings of the symbols

Following symbols are used in the various sections of this manual:



Important information and useful hints about usage.



**WARNING:** Warnings against dangerous situations concerning the security of life and property.



**WARNING:** Warning for hot surfaces.



**WARNING:** Risk of burning and scalding due to steam.



**WARNING:** Warning for electric shock.











This product has been manufactured in environmental friendly modern plants without giving any harm to the nature.

1. Lime collecting cartridge
2. Steam station
3. Water reservoir removal latch
4. Removable water reservoir
5. Water refill lid
6. Steam station surface
7. Soleplate
8. Transport lock
9. Control panel
10. On/off and control button
11. Steam trigger

### Technical data

<b>Model</b>	<b>SIS 6126 R</b>
<b>Power supply</b>	220-240V~, 50-60 Hz
<b>Power consumption</b>	2190-2600W
<b>Pump pressure</b>	6 bar
<b>Continuous steam amount</b>	Up to 110 g/min.
<b>Color</b>	Red

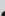
Technical and design modification rights are reserved.

Control panel	Symbols	Descriptions
		Change cartridge / Self clean
		Auto shut off / Self clean
		Max level of temperature and max level of steam
		Level 3 of temperature and level 2 of steam
		Level 2 of temperature and level 1 of steam
		Level 1 of temperature and no steam
		Smart-ECO mode

The values which are declared in the markings affixed on your product or the other printed documents supplied with it represent the values which have been obtained in the laboratories pursuant to the pertinent standards. These values may vary according to the usage of the appliance and ambient conditions.

# 1 Important safety and environmental instructions

This section contains safety instructions that will help protect from risk of personal injury or material damage.

Failure to follow these instructions invalidates the granted warranty.

## 1.1 General safety

- This appliance complies with the international safety standards.
  - This appliance is intended to be used in household and similar applications such as:
    - Staff kitchen areas in shops, offices and other working environments;
    - Farm houses
    - By clients in hotels, and other residential type environments;
    - Bed and Breakfast type environments.
- It is not fit for industrial use.
- This appliance is not intended for use by persons (including children) with reduced physical, sensory or mental capabilities or lack of experience and knowledge, unless they have been given supervision or instruction concerning the use of the appliance by a person responsible for their safety.
  - Children should be supervised to ensure that they do not play with the appliance.
  - Do not leave the appliance unattended while it is plugged in.
  - Unplug the appliance before filling the water reservoir with water.
  - Do not open the water refill hole during usage.
  - Operate and store the appliance on a stable surface.
  - When the appliance is placed on its base plate, ensure that the surface beneath the plate is level.

# 1 Important safety and environmental instructions

- Always rest your iron on the base.
- If the appliance is dropped or leaks water or has other failures, contact the authorised service. Do not use the appliance until it is repaired.
- When the appliance is in use or left to cool down, keep the appliance and power cable out of reach of children under 8 years old.
- The appliance is not suitable for outdoor use.
- Only use the original parts or parts recommended by the manufacturer.
- Use the appliance only when it is connected to the steam iron station.
- Do not dismantle the appliance.
- Your mains power supply should comply with the information supplied on the rating plate of the appliance.
- The mains supply of the appliance should be secured with a 16 A fuse minimum.
- Use the appliance with a grounded outlet.
- Do not use the appliance with an extension cable.
- Do not pull the power cable when unplugging the appliance.
- If the power cable is damaged, it should be repaired or replaced by the dealer, service center, or a specialised and authorised service with similar qualifications.
- Unplug the appliance before cleaning.
- Do not wrap the cable around the appliance.
- Do not touch the appliance or its plug with damp or wet hands when the appliance is plugged in.
- The soleplate and the steam station surface may get overheated. Contact with hot surfaces may cause burns.
- Do not use the appliance in or near the areas where combustible or inflammable places and materials exist.



# 1 Important safety and environmental instructions

- If you keep the packaging materials, store them out of the reach of children.
- For detailed information on cleaning the appliance, please refer to the section Cleaning and maintenance.

## 1.2 Compliance with WEEE Directive and Disposing of the Waste Product

This product complies with EU WEEE Directive (2012/19/EU). This product bears a classification symbol for waste electrical and electronic equipment (WEEE).



This symbol indicates that this product shall not be disposed with other household wastes at the end of its service life. Used device must be returned to official collection point for recycling of

electrical and electronic devices. To find these collection systems please contact to your local authorities or retailer where the product was purchased. Each household performs important role in recovering and recycling of old appliance. Appropriate disposal of used appliance helps prevent potential negative consequences for the environment and human health.

## 1.3 Compliance with RoHS Directive

The product you have purchased complies with EU RoHS Directive (2011/65/EU). It does not contain harmful and prohibited materials specified in the Directive.

## 1.4 Package information



Packaging materials of the product are manufactured from recyclable materials in accordance with our National Environment Regulations. Do not dispose of the packaging materials together with the domestic or other wastes. Take them to the packaging material collection points designated by the local authorities.

## 2 Operation

### 2.1 Intended use

This appliance is intended only for household use and ironing; it is not suitable for professional use.

### 2.2 Initial use



- Prior to initial use, fill the water reservoir (4) with water and evaporate the water twice in order to remove the manufacturing residues.
- A light odour may arise during the initial use. This condition will return to normal after several uses.

### 2.3 Ironing tips

- The appliance gets heated in a short time; iron fabrics such as synthetic, silk etc. using low temperature settings.
- Iron fabrics that may luster (silk etc.) by turning them inside out or using the appliance in Smart-ECO mode.
- Use very little pressure when ironing fabrics such as velvet and iron them towards one single direction.
- Steam usage may cause stains on coloured silk fabrics. Do not use steam.
- 100% pure woolen clothes can be ironed by using steam.
- Ironing woolen clothes may cause luster. Iron by turning them inside out.



**WARNING:** Do not allow the iron to contact with metal parts such as zippers and rivets. This may damage the soleplate of the iron.

### 2.4 Temperature setting

Fabric Type	Temperature Setting	Steam Setting
Synthetic	•	Without steam
Silk	••	With Steam
Cotton	•••	With Steam
Linen - Jean	Max	With Steam



Smart-ECO mode of your appliance is suitable for all types of fabrics that can be ironed. You can iron securely. You can do steam ironing by using the steam trigger (11) in this mode.



#### WARNING

- You can do steam ironing at all temperature levels except for “•” Press the steam trigger (11) for steam ironing.
- Take the ironing instructions specified on the label of the fabric into consideration for ironing.

### 2.5 Dry ironing

Your appliance will not raise steam as long as you do not press the steam trigger (11).

In order to use dry ironing, do not press the steam trigger (11).

### 2.6 Filling the water reservoir



**WARNING:** When filling the water reservoir with water without removing it from the steam station, ensure that the appliance is unplugged.

## 2 Operation

- If you press the steam button (11) while the water reservoir is empty, three steam level symbols other than the first level and the smart mode symbol light flash as shown in the figure.

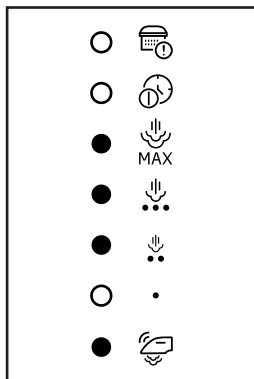

- When user presses function button after installing the tank with water, the light will return to previous mode.
- Your appliance is suitable for using with tap water. If your tap water is excessively hard, we recommend you to use a mixture of tap water and potable water.

### 2.7 Steam ironing

- Operation of the pump may make some noise during the water drawing process; this is normal.
- The appliance starts in Smart-ECO mode in the initial use. This level offers safe temperature and steam amount for all the fabrics that can be ironed.
- When the icon light of the selected setting flashes consistently on the display, your appliance is ready to iron.

#### WARNING



- Your selection should be suited for the fabric to be ironed.
- If the icon light on the display blinks, this means that the soleplate temperature setting is not at the desired level.



- You can do steam ironing by using the steam trigger (11) at all temperature levels except for “●”.
- Your iron will raise steam from its soleplate (7) as long as you hold the steam trigger pressed.

### 2.8 Vertical steam



You can iron your curtains and hanged garments thanks to the vertical steam feature. Keep the appliance 15-30 cm away from the garment and curtains.



**WARNING:** Never direct the steam to people or pets.

### 2.9 Automatic Shutdown (Auto-Off)



- If you do not move the appliance or press any of its buttons for 10 minutes, it will be shut down automatically.
- If you move the appliance horizontally or press any of its buttons, it will start to operate.
- It may take 60 seconds for the soleplate (7) to reach the previous temperature level.

## 3 Cleaning and care

### 3.1 Cleaning

#### WARNING



- Do not soak the steam station (2) in water or other liquids. Never put vinegar, descaling agent, laundry starch, perfume or other auxiliary products that help ironing into the appliance.
- Do not use gasoline, solvent and abrasive cleaning agents or hard brush to clean the appliance.
- Do not use abrasive cleaning agents to clean the soleplate (7).



**WARNING:** Do not wash your appliance under running water or do not soak it in water or other liquids.

### 3.2 Replacing the lime collecting cartridge

#### WARNING



- Do not use any descaling agents! They may damage the appliance.
- Do not purchase cartridge from places other than the dealers and service centers. If you do this, the cartridge will not fit into the cartridge slot and will not operate. This causes a breakdown in your appliance. Faults arising from using wrong cartridge are not covered under warranty.
- If the scale collection cartridge is not installed or if it is installed incorrectly, the cartridge replacement symbol light flashes to warn the user that the cartridge is installed incorrectly.



The cartridge must be replaced after consuming about 30 liters of water.

### 3.3 Lime removing feature (Self-Clean)

- To start descaling operation, press control (10) and steam (11) buttons simultaneously for 3 seconds.
- The appliance returns to the last used mode when descaling (self-scaling) operation is ended.
- After consuming about 15 liters of water, "Self-clean" icon lights lit continuously on as shown in the picture indicating the need for self-cleaning process.

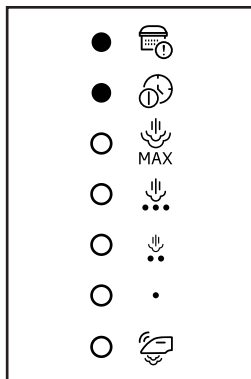

- The relevant symbols are illuminated continuously during the descaling operation, and the user is not allowed to turn off this mode until descaling operation is ended.
- During self-cleaning process, user cannot exit until the self-clean is completed.
- If user skips self-cleaning process or plugs the iron off, the appliance will remind this need of self-cleaning operation with related icon lights and buzzer sounds simultaneously for three times at the beginning of every ironing session.

## 3 Cleaning and care



- When the lime removing (self-clean) is over, the appliance automatically returns to the previous mode.

### 3.4 Storage

- If you do not intend to use the appliance for a long time, store it carefully.
- Unplug the appliance and wait for it to cool completely before storing it.
- Discharge the water in the water reservoir (5).
- Store the appliance in a cool and dry place.
- Keep the appliance out of the reach of children.

### 3.5 Moving and transportation

- Carry the appliance in its original packaging during moving and transportation. The packaging of the appliance protects it against physical damages.
- Do not place heavy loads on the appliance or the packaging. The appliance may be damaged.
- Dropping the appliance may render it non-operational or cause permanent damage.



For commissioning, general use and cleaning, please observe the instructions on pages 5 - 6 and 7 of this operating manual.

## Branches

If you have followed the instructions and still have a problem, contact the customer care line on 086 100 3339. They will be able to advise you on any aspect of the appliance.

---

### South African Branches:

#### **BLOEMFONTEIN**

Unit Number 5  
Monument Business Park  
50 Monument Road  
Oranjesig, Bloemfontein  
[Bloemfontein.Service@defy.co.za](mailto:Bloemfontein.Service@defy.co.za)

#### **CAPE TOWN**

5A Marconi Rd. Montague Gardens, 7441  
[CapeTown.Service@defy.co.za](mailto:CapeTown.Service@defy.co.za)

#### **DURBAN**

135 Teakwood Road, Jacobs,  
Durban, 4052  
[Durban.Service@defy.co.za](mailto:Durban.Service@defy.co.za)

#### **EAST LONDON**

Robbie de Lange Road, Wilsonia,  
East London, 5201  
[EastLondon.Service@defy.co.za](mailto:EastLondon.Service@defy.co.za)

#### **GAUTENG, MIDRAND**

127 15th Road, Cnr Pharmaceutical & 15th Rd,  
Midrand, Gauteng  
[Gauteng.Service@defy.co.za](mailto:Gauteng.Service@defy.co.za)

#### **POLOKWANE**

87 Nelson Mandela Drive, Superbia 0699  
[Polokwane.Service@defy.co.za](mailto:Polokwane.Service@defy.co.za)

#### **PORT ELIZABETH**

112 Patterson Road, North End, Port Elizabeth  
6001  
[PortElizabeth.Service@defy.co.za](mailto:PortElizabeth.Service@defy.co.za)

### Sub-Saharan Africa Branches:

#### **ZAMBIA: SOUTHGATE INVESTMENTS LTD**

Plot 1606, Sheki Sheki Road  
P.O. Box 33681  
Lusaka, 10101, Zambia  
Tel: +260 0211 242332/3  
Fax: +260 0211 242933  
[sgiservicecentre@microlink.zm](mailto:sgiservicecentre@microlink.zm)

#### **NAMIBIA: ATLANTIC DISTRIBUTORS (PTY) LTD**

10 Tienie Louw Street, Northern Industrial Area  
P.O. Box 21158, Windhoek, Namibia  
Tel: (061) 216162  
Fax: (061) 216134  
[atlantic@mwweb.com.na](mailto:atlantic@mwweb.com.na)

#### **ZIMBABWE: TRADECOMAFRICA**

Trade Com Africa, 183 Loreley Crescent  
Msasa, Harare, Zimbabwe  
Tel: +263 4 486165/6  
Cell: +263 772 469010  
Cell: +263 772 469011

#### **BOTSWANA: RAY MORGAN AGENCIES**

RMA Service Centre, Plot 48, East Gate  
Gaborone International Commerce Park  
Kgale View, Gaborone  
Botswana  
Tel: +267 390 3996 / 390 3912  
Fax: +267 318 7376  
Cell: +267 7134 6539  
[service@rma.co.bw](mailto:service@rma.co.bw); [raja@rma.co.bw](mailto:raja@rma.co.bw)

#### **SWAZILAND: LYND'S DISTRIBUTORS**

P.O Box 716, Mbabane, Swaziland, H100  
Tel: (00268) 2515 4310/8  
Fax: (00268) 2518 4318

#### **MOZAMBIQUE: COOL WORLD. LDA**

Rua da Resistencia No. 97B R/C  
Cell: +258 84 44 61 234  
[coolworldlda@hotmail.com](mailto:coolworldlda@hotmail.com)  
Nosso Show Room  
Av: da Industrias, Parcela No.735 \* 735A  
Machava, Maputo

## Warranty

---

This certificate is issued by DEFY APPLIANCES (PTY) LIMITED manufacturers of Defy and Ocean products, hereinafter the Company, to the original purchaser only, of the appliance described on the certificate and shall constitute the only warranty given in respect of this appliance.

The Company warrants to the original purchaser that for a period of TWO YEARS from date of purchase the appliance is free from defect under normal domestic use, both in workmanship and material, subject to the following conditions.

1. Carry-in service. Small appliances are repaired in our service centres and are not collected from the customers home. Faulty units must be delivered to the purchasing dealer or to the nearest Company Service Centre for warranty repairs.
2. Vitreous enamelware, fuses and lamps are specifically excluded from these warranties. It is an express condition of these warranties that the purchaser takes due care and attention in the use and maintenance of the appliance. Abuse, misuse in conflict with operating instructions, connection to incorrect voltages and subjection to commercial use shall release the Company from its obligations.
3. This warranty shall become void and cease to operate if the appliance is dismantled by, or any repairs to the appliance are effected by any persons not duly authorised by the Company, or if substitute parts not approved by the Company are used in the appliance, or if the serial number of the appliance is removed.
4. The Company shall not be responsible for damages resulting from fire, flood, civil disturbances or any Act of God. The Company shall not, in terms of these warranties be responsible nor held liable for any consequential loss or damage of any kind caused by or due to the failure or malfunction of the appliance. The Company shall not be responsible for damages caused by insect and/or animal infestation.
5. The Company shall not be responsible for transportation or other costs other than those incurred within the provisions of Point 1 of this Certificate.
6. **For warranties in the Republic of South Africa and Sub-Saharan Africa, please contact your nearest Defy office. Please refer to the previous page for respective South African branches and Sub-Saharan Africa branches.**
7. Where service is requested under warranty and no fault or defect can be found by the Company, all costs incurred will be for the purchaser's account.
8. This Certificate as well as your invoice will serve as proof of purchase. For the purpose of warranty, it will be essential to produce this Certificate and invoice. Failure to do so, will render the purchaser liable for service costs.

**KEEP THIS CERTIFICATE AND SALES INVOICE AS PROOF OF  
PURCHASE FOR WARRANTY PURPOSES.**

