

**MAC 7030 W**  
**AIR COOLER**

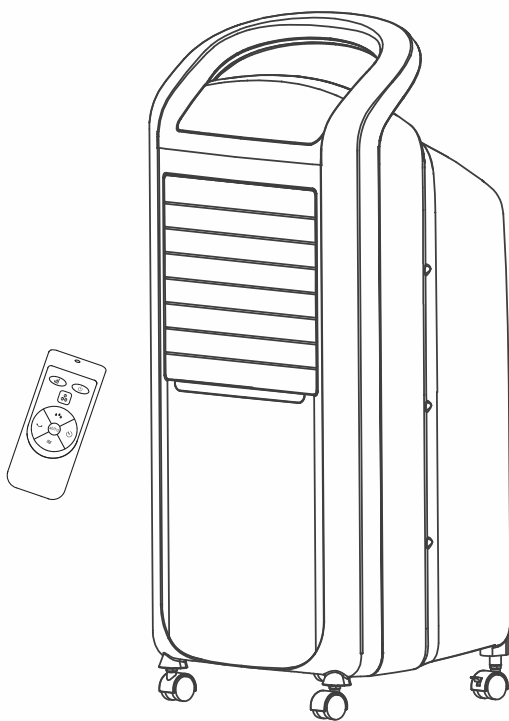

Believe in better



**Customer Care Line**  
(after sales service)

**086 100 3339**

**Small Appliance**

Instruction manual







# Please read this user manual first!

Dear Customer,

Thank you for preferring a Defy product. We hope that you get the best results from your product which has been manufactured with high quality and state-of-the-art technology. Therefore, please read this entire user manual and all other accompanying documents carefully before using the product and keep it as a reference for future use. If you handover the product to someone else, give the user manual as well. Follow all warnings and information in the user manual.

## Meanings of the symbols

Following symbols are used in the various section of this manual:

	Important information or useful hints about usage.
	Warning for hazardous situations with regard to life and property.
	Warning to actions that must never perform.
	Warning for electric shock.
	Warning for danger of fire.
	Warning for hot surfaces.

This product has been produced in environmentally friendly, modern facilities

Complies with the WEEE Regulation.



# CONTENTS

---

<b>1 Safety instructions</b>	<b>4</b>
<b>2 Installation instructions</b>	<b>5</b>
2.1 Name of components .....	5
<b>3 Instructions for use</b>	<b>6</b>
3.1 Instructions for key of remote controller .....	6
3.2 Instructions for operation of body .....	7
<b>4 Other</b>	<b>8</b>
4.1 Maintenance instruction .....	8
4.2 Cleaning .....	8
4.3 Technical data .....	8

# 1 Safety instructions

## Warning

Read rules for safe operation and instructions carefully.

- If the supply cord is damaged, it must be replaced by manufacturer or its service agent or a similarly qualified person in order to avoid a hazard.
- Household Indoor use only.
- This appliance can be used by children aged from 8 years and above and persons with reduced physical, sensory or mental capabilities or lack of experience and knowledge if they have been given supervision or instruction concerning use of the appliance in a safe way and understand the hazards involved. Children shall not play with the appliance. Cleaning and user maintenance shall not be made by children without supervision. Young children should be supervised to ensure that they do not play with the appliance.
- Unplug the appliance during filling and cleaning.
- Prior to cleaning or other maintenance, the appliance must be disconnected from the supply mains.
- Correct disposal of this product



- This marking indicates that this product should not be disposed with other household wastes throughout the EU. To prevent possible harm to the environment or human health from uncontrolled waste disposal, recycle it responsibly to promote the sustainable reuse of material resources. To return your used device, please use the return and collection systems or contact the retailer where the product was purchased. They can take this product for environmental safe recycling.

## 2 Installation instructions

### 2.1 Name of components

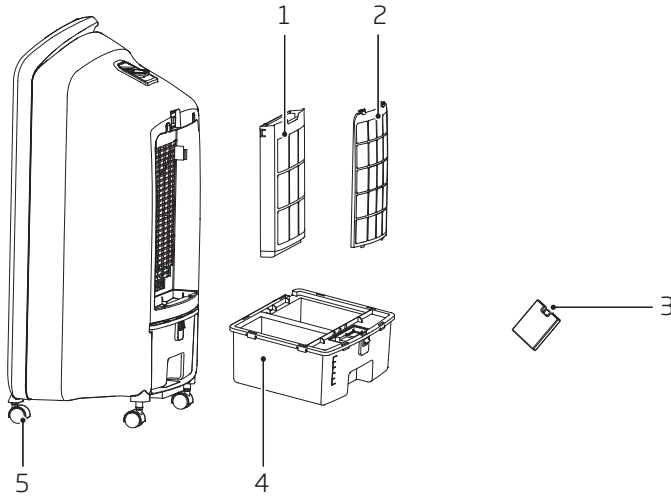

1. Honeycomb filter frame
2. Pre-filter
3. Ice box
4. Water tank
5. Wheel

### Foot-wheel installation

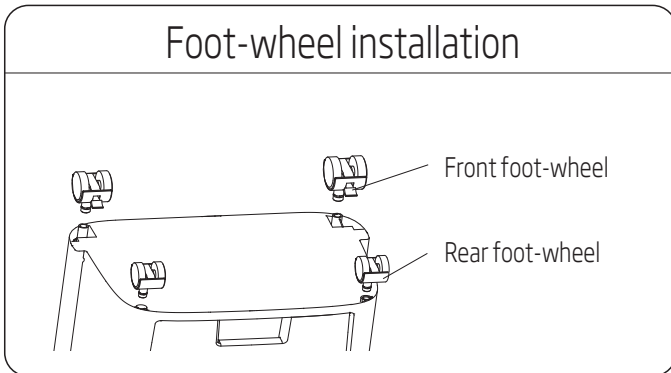

## 3 Instructions for use

### 3.1 Instructions for key of remote controller

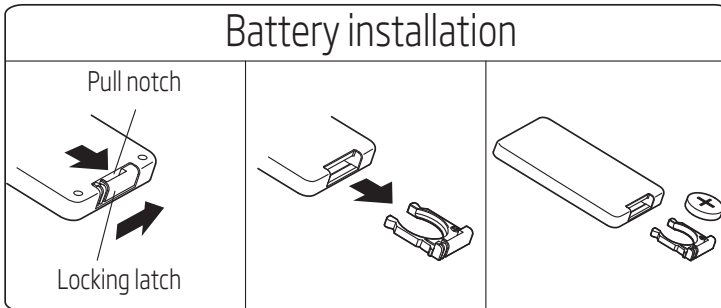
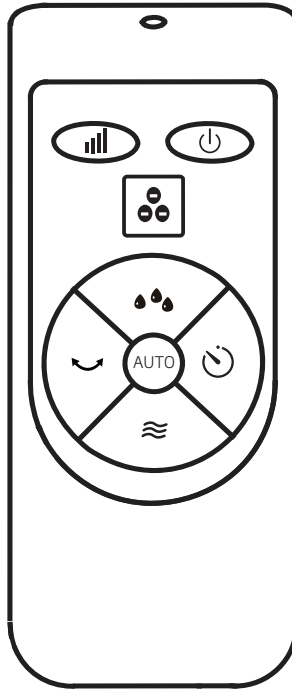

#### Considerate hint:



1. Install the battery with positive side facing up.
2. Effective range of remote control: within 5m distance and 30-degree deflection in front of product.

## 3 Instructions for use

### 3.2 Instructions for operation of body

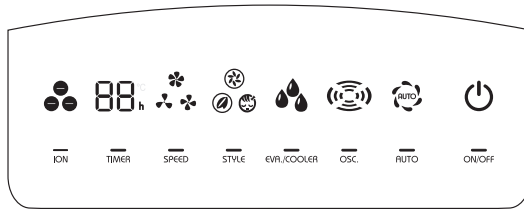

Press a key on the unit to activate a corresponding function.

For instance:

- Press [OSC] key to activate or deactivate swing function.
- Press [Speed] key to adjust 3 speeds of air flow.
- Press [Style] key to switch between normal, natural and sleep functions.
- Press [Timer] key to set 1-12 hour timer setting.
- Press [Ion] key to activate or deactivate negative Ion function.
- When [Eva./Cooler] key is pressed, the indicator lights up constantly if the operation is normal; when the indicator flashes, it denotes a water shortage, please add water immediately.



#### Considerate hint:

Push buttons on the unit may differ based on the actual product model.

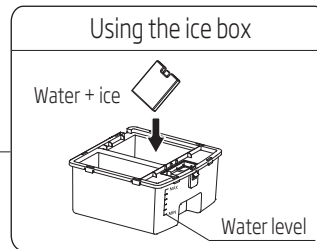
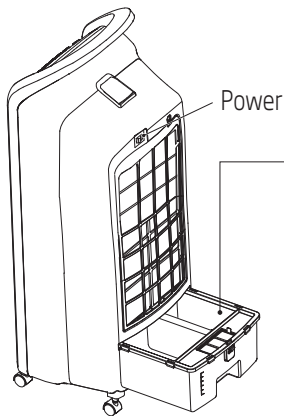

#### Considerate hint:

When humidifying, water level in the water tank must remain under max indication; replenish water if level gets lower than min indication.

## 4 Other

### 4.1 Maintenance instruction

The fan requires little maintenance. Do not try to fix it by yourself. Refer it to qualified service personnel if service is needed.

1. Before cleaning and assembling, fan must be unplugged.
2. To ensure adequate air circulation to the motor, keep vents at the rear of the motor free of dust. Do not disassemble the fan to remove dust.
3. Please wipe the exterior parts with a soft cloth soaking a mild detergent.
4. Do not use any abrasive detergent or solvents to avoid scratching the surface. Do not use any of the following as a cleaner: gasoline, thinner.
5. Do not allow water or any other liquid into the motor housing or interior parts.

### 4.2 Cleaning

1. Be sure to unplug from the electrical supply source before cleaning.
2. Plastic parts should be cleaned with a soft cloth moisten with mild soap. Thoroughly remove soap film with dry cloth.

### 4.3 Technical data

**Power supply:** 220V-240V, 50Hz

Technical and design modifications reserved.

Information			
Description	Symbol	Value	Unit
Maximum fan flow rate	F	7.5	m <sup>3</sup> /min
Fan power input	P	100	W
Service value	SV	0.08	(m <sup>3</sup> /min)/W
Standby power consumption	P <sub>SB</sub>	0.5	W
Fan sound power level	L <sub>WA</sub>	65	dB(A)
Maximum air velocity	C	27.00	meters/sec
Measurement standard for service value	ISO 5801:1997		



**5****Branches**

If you have followed the instructions and still have a problem, contact the customer care line on 086 100 3339. They will be able to advise you on any aspect of the appliance.

**South African Branches:****BLOEMFONTEIN**

Unit Number 5  
 Monument Business Park  
 50 Monument Road  
 Oranjesig, Bloemfontein  
[Bloemfontein.Service@defy.co.za](mailto:Bloemfontein.Service@defy.co.za)

**CAPE TOWN**

5A Marconi Rd. Montague Gardens, 7441  
[CapeTown.Service@defy.co.za](mailto:CapeTown.Service@defy.co.za)

**DURBAN**

135 Teakwood Road, Jacobs,  
 Durban, 4052  
[Durban.Service@defy.co.za](mailto:Durban.Service@defy.co.za)

**EAST LONDON**

Robbie de Lange Road, Wilsonia,  
 East London, 5201  
[EastLondon.Service@defy.co.za](mailto:EastLondon.Service@defy.co.za)

**GAUTENG, MIDRAND**

127 15th Road, Cnr Pharmaceutical & 15th Rd,  
 Midrand, Gauteng  
[Gauteng.Service@defy.co.za](mailto:Gauteng.Service@defy.co.za)

**POLOKWANE**

87 Nelson Mandela Drive, Superbia 0699  
[Polokwane.Service@defy.co.za](mailto:Polokwane.Service@defy.co.za)

**PORT ELIZABETH**

112 Patterson Road, North End, Port Elizabeth  
 6001  
[PortElizabeth.Service@defy.co.za](mailto:PortElizabeth.Service@defy.co.za)

Record in the space below the listed information for future reference.

SERIAL NUMBER.....

DATE OF PURCHASE.....

PURCHASED FROM.....

**Sub-Saharan Africa Branches:****ZAMBIA: SOUTHGATE INVESTMENTS LTD**

Plot 1606, Sheki Sheki Road  
 P.O. Box 33681  
 Lusaka, 10101, Zambia  
 Tel: +260 0211 242332/3  
 Fax: +260 0211 242933  
[sgiservicecentre@microlink.zm](mailto:sgiservicecentre@microlink.zm)

**NAMIBIA: ATLANTIC DISTRIBUTORS (PTY) LTD**

10 Tienie Louw Street, Northern Industrial Area  
 P.O. Box 21158, Windhoek, Namibia  
 Tel: (061) 216162  
 Fax: (061) 216134  
[atlantic@mweb.com.na](mailto:atlantic@mweb.com.na)

**ZIMBABWE: TRADECOMAFRICA**

Trade Com Africa, 183 Loreley Crescent  
 Msasa, Harare, Zimbabwe  
 Tel: +263 4 486165/6  
 Cell: +263 772 469010  
 Cell: +263 772 469011

**BOTSWANA: RAY MORGAN AGENCIES**

RMA Service Centre, Plot 48, East Gate  
 Gaborone International Commerce Park  
 Kgale View, Gaborone  
 Botswana  
 Tel: +267 390 3996 / 390 3912  
 Fax: +267 318 7376  
 Cell: +267 7134 6539  
[service@rma.co.bw](mailto:service@rma.co.bw); [raja@rma.co.bw](mailto:raja@rma.co.bw)

**SWAZILAND: LYNDS DISTRIBUTORS**

P.O Box 716, Mbabane, Swaziland, H100  
 Tel: (00268) 2515 4310/8  
 Fax: (00268) 2518 4318

**MOZAMBIQUE: COOL WORLD. LDA**

Rua da Resistencia No. 97B R/C  
 Cell: +258 84 44 61 234  
[coolworldlda@hotmail.com](mailto:coolworldlda@hotmail.com)  
 Nosso Show Room  
 Av: da Industrias, Parcela No.735 \* 735A  
 Machava, Maputo

## 6 Warranty

---

This certificate is issued by DEFY APPLIANCES (PTY) LIMITED manufacturers of Defy and Ocean products, hereinafter the Company, to the original purchaser only, of the appliance described on the certificate and shall constitute the only warranty given in respect of this appliance.

The Company warrants to the original purchaser that for a period of TWO YEARS from date of purchase the appliance is free from defect under normal domestic use, both in workmanship and material, subject to the following conditions.

1. Carry-in service. Small appliances are repaired in our service centres and are not collected from the customers home. Faulty units must be delivered to the purchasing dealer or to the nearest Company Service Centre for warranty repairs.
2. Vitreous enamelware, fuses and lamps are specifically excluded from these warranties. It is an express condition of these warranties that the purchaser takes due care and attention in the use and maintenance of the appliance. Abuse, misuse in conflict with operating instructions, connection to incorrect voltages and subjection to commercial use shall release the Company from its obligations.
3. This warranty shall become void and cease to operate if the appliance is dismantled by, or any repairs to the appliance are effected by any persons not duly authorised by the Company, or if substitute parts not approved by the Company are used in the appliance, or if the serial number of the appliance is removed.
4. The Company shall not be responsible for damages resulting from fire, flood, civil disturbances or any Act of God. The Company shall not, in terms of these warranties be responsible nor held liable for any consequential loss or damage of any kind caused by or due to the failure or malfunction of the appliance. The Company shall not be responsible for damages caused by insect and/or animal infestation.
5. The Company shall not be responsible for transportation or other costs other than those incurred within the provisions of Point 1 of this Certificate.
6. **For warranties in the Republic of South Africa and Sub-Saharan Africa, please contact your nearest Defy office. Please refer to the previous page for respective South African branches and Sub-Saharan Africa branches.**
7. Where service is requested under warranty and no fault or defect can be found by the Company, all costs incurred will be for the purchaser's account.
8. This Certificate as well as your invoice will serve as proof of purchase. For the purpose of warranty, it will be essential to produce this Certificate and invoice. Failure to do so, will render the purchaser liable for service costs.

**KEEP THIS CERTIFICATE AND SALES INVOICE AS PROOF OF  
PURCHASE FOR WARRANTY PURPOSES.**